

## D30-2



### Deep suction cup

- Suitable for objects with curved or irregular surfaces.
- Grips around corners and edges.

### Lifting forces & Technical data

Lifting force vertical to the surface, N, at vacuum level			Lifting force parallel to the surface, N, at vacuum level			Volume	Min. curve radius	Max. vertical movement	Weight rubber part
20 -kPa	60 -kPa	90 -kPa	20 -kPa	60 -kPa	90 -kPa	cm <sup>3</sup>	mm	mm	g
14.0	26	31	—	—	—	5.0	13	5.0	4.0

### Material specifications

Material	Colour	Hardness °Shore A	Temperature range °C
Chloroprene, CR	Black	50	-40–110
Silicone, SIL	Red	50	-40–200

### Material resistance

Material	Wear resistance	Oil	Weather & ozone	Hydrolysis	Petrol	Concentrated acids	Alcohol	Oxidation
Chloroprene, CR	Excellent	Fair	Good	Good	Fair	Poor	Good	Good
Silicone, SIL	Good	Poor	Excellent	Fair	Poor	Poor	Good	Excellent

### Ordering information

	Complete suction cups	Art. No.
A	Suction cup D30-2 Chloroprene, M5 female	0101237
B	Suction cup D30-2 Chloroprene, G1/8" male, with mesh filter	0101238
B	Suction cup D30-2 Chloroprene, G1/8" male, with mesh filter and dual flow control valve	0101244
C	Suction cup D30-2 Chloroprene, G1/8" male/M5 female, with mesh filter	0101242
C	Suction cup D30-2 Chloroprene, G1/8" male/M5 female, with dual flow control valve	0101246
A	Suction cup D30-2 Silicone, M5 female	0101248
B	Suction cup D30-2 Silicone, G1/8" male, with mesh filter	0101249
C	Suction cup D30-2 Silicone, G1/8" male/M5 female, with mesh filter	0101253
D	Suction cup D30-2 Silicone, 5xM5 female	0101252
E	Suction cup D30-2 Silicone, G1/8" male/M5 female, PA	0110332

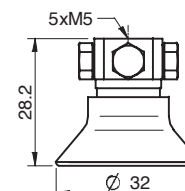
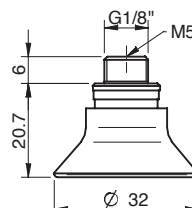
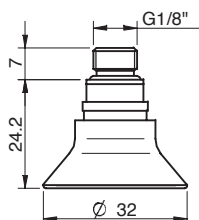
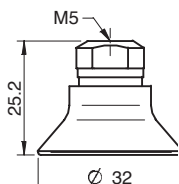

<Picture\_Text changed="2004-04-27 11:13:03">A

<Picture\_Text changed="2004-04-27 11:13:19">B

<Picture\_Text changed="2004-04-27 11:13:35">C

<Picture\_Text changed="2004-04-27 11:13:58">D

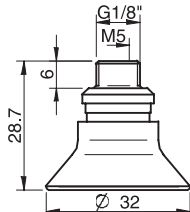

<Picture\_Text changed="2004-04-27 11:14:21">E

Rubber parts	Art. No.
Suction cup D30-2 Chloroprene	0101125
Suction cup D30-2 Silicone	0101126

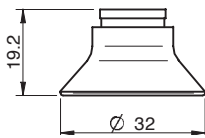

<Picture\_Text changed="2004-04-27 11:14:33">

Fittings	Art. No.
Fitting M5 female	3250003
Fitting M5 female, with dual flow control valve	3251001
Fitting G1/8" male, with mesh filter	3250085
Fitting G1/8" male, with mesh filter and dual flow control valve	3251002
Fitting G1/8" male/M5 female, with mesh filter	0101152
Fitting G1/8" male/M5 female, with dual flow control valve	3251004
Fitting 5xM5 female	0100260
Fitting 5xM5 female, with dual flow control valve	3251005
Fitting G1/8" male/M5 female, PA	3150196