

F20MF



Flat suction cup with cleats, mark free

- ▶ Suction cup of TPU, a mark free material that leaves no trace on the object being handled.
- ▶ Suitable for flat surfaces.
- ▶ Good stability and little inherent movement.
- ▶ Recommended when the lifting force is parallel to the surface of the object.

Lifting forces & Technical data

Lifting force vertical to the surface, N, at vacuum level			Lifting force parallel to the surface, N, at vacuum level			Volume cm ³	Min. curve radius mm	Max. vertical movement mm	Weight rubber part g
20 -kPa	60 -kPa	90 -kPa	20 -kPa	60 -kPa	90 -kPa				
3.6	14.5	22.0	8.0	14.5	21.0	1.0	18	2.0	1.2

Material specifications

Material	Colour	Hardness °Shore A	Temperature range °C
Thermoelastic polyurethane, TPU	Transparent white	81	-20-80

Material resistance

Wear resistance	Oil	Weather & Ozone	Hydrolysis	Petrol	Concentrated acids	Alcohol	Oxidation
Excellent	Excellent	Excellent	Poor	Poor	Poor	Good	Good

Ordering information

	Complete suction cups	Art. No.
A	Suction cup F20MF Thermoelastic polyurethane, M5 female	0101281
B	Suction cup F20MF Thermoelastic polyurethane, G1/8" male, with mesh filter	0101282
B	Suction cup F20MF Thermoelastic polyurethane, G1/8" male, with mesh filter and dual flow control valve	0101288
C	Suction cup F20MF Thermoelastic polyurethane, G1/8" male / M5 female, with mesh filter	0101286
C	Suction cup F20MF Thermoelastic polyurethane, G1/8" male / M5 fem., with dual flow control valve	0101290
D	Suction cup F20MF Thermoelastic polyurethane, 5xM5 female	0101285
D	Suction cup F20MF Thermoelastic polyurethane, 5xM5 female, with dual flow control valve	0101291

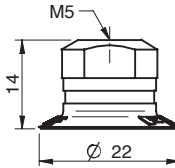

<Picture_Text changed="2004-04-27 13:52:03">A

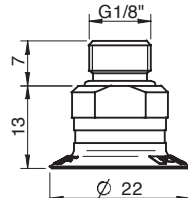

<Picture_Text changed="2004-04-27 13:52:16">B

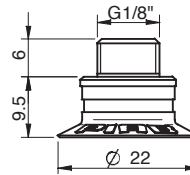

<Picture_Text changed="2004-04-27 13:52:37">C

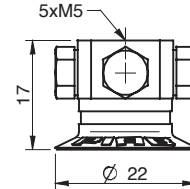

<Picture_Text changed="2004-04-27 13:52:54">D

	Rubber parts	Art. No.
	Suction cup F20MF Thermoelastic polyurethane	0101139

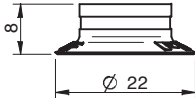

<Picture_Text changed="2004-04-27 13:53:06">

	Fittings	Art. No.
	Fitting M5 female	3250003
	Fitting M5 female, with dual flow control valve	3251001
	Fitting G1/8" male, with mesh filter	3250085
	Fitting G1/8" male, with mesh filter and dual flow control valve	3251002
	Fitting G1/8" male/M5 female, with mesh filter	0101152
	Fitting G1/8" male/M5 female, with dual flow control valve	3251004
	Fitting 5xM5 female	0100260
	Fitting 5xM5 female, with dual flow control valve	3251005
	Fitting G1/8" male/M5 female, PA	3150196