

Feed nozzles 25, 32, 40, 50



- ▶ Polished $\leq Ra 0.8$.
- ▶ To pick up the product in a smooth manner.
- ▶ Adjustable air intake at two places.

Technical data

| Description | Value |
|-------------|----------------|
| Material | ASTM 316L, POM |

Technical data, specific

| Description | Unit | Value | | | |
|-------------|------|---------|---------|---------|---------|
| | | 0117440 | 3404001 | 3104055 | 3104054 |
| Weight | kg | 1.41 | 2.62 | 2.90 | 2.99 |

Ordering information

| Description | Art. No. |
|-------------------------------|----------|
| Feed nozzle 25 without handle | 0117440 |
| Feed nozzle 32 | 3404001 |
| Feed nozzle 40 | 3104055 |
| Feed nozzle 50 | 3104054 |

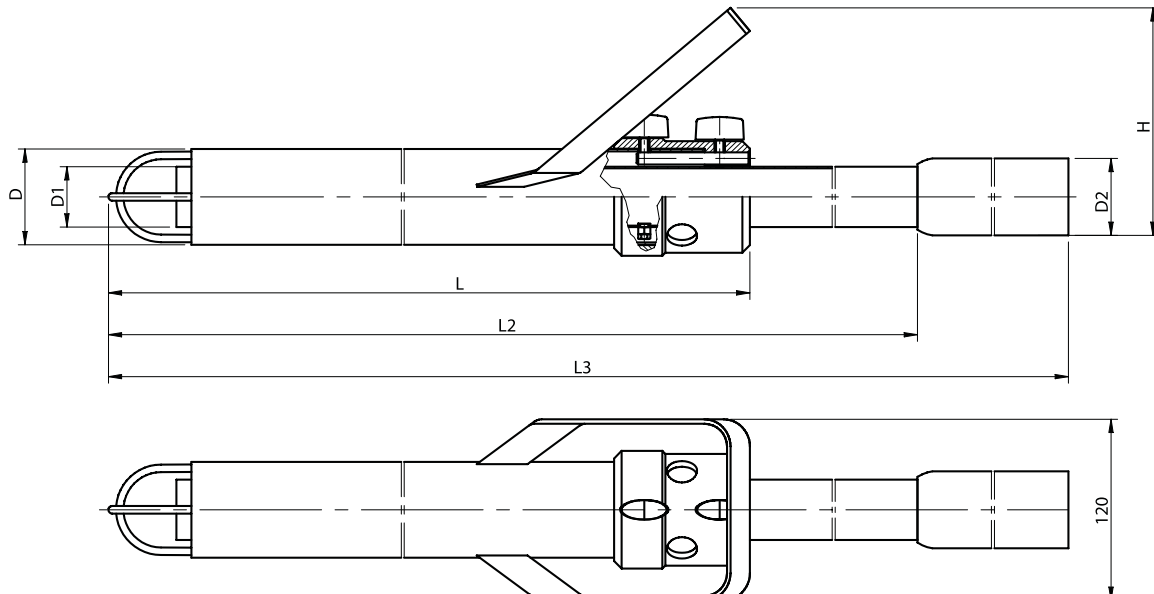

Dimensions

| Description | D mm | D1 mm | D2 mm | L mm | L2 mm | L3 mm | H mm |
|-------------------------------|--------|----------|----------|------|----------|----------|------|
| Feed nozzle 25 without handle | Ø 40.0 | Ø 25x1.2 | Ø 25x1.2 | 730 | 911-940 | — | 66 |
| Feed nozzle 32 | Ø 51.0 | Ø 32x1.2 | Ø 32x1.2 | 780 | 940-1005 | — | 160 |
| Feed nozzle 40 | Ø 63.5 | Ø 40x1.0 | Ø 40x1.0 | 785 | 840-905 | — | 165 |
| Feed nozzle 50 | Ø 63.5 | Ø 40x1.0 | Ø 51x1.5 | 785 | 840-905 | 940-1005 | 165 |